

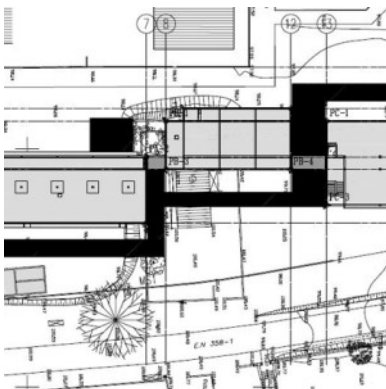

LINHACEIRA – PRIMARY GRADE SCHOOL AND KINDERGARTEN

PRELIMINARY DESIGN AND DETAILED DESIGN INCLUDING URBAN INSERTION AND LANDSCAPE



Client: Municipality of Tomar – Portugal

Location: Tomar, Portugal

Design date: 2010

Construction date: 2011

Design by: NSE / GIMA Projectos, Lda.

Services: Preliminary Design and Detailed Design including urban insertion and landscape

Summary:

This Building includes 4 blocks with 1 to 3 floors with a total construction area of 4 155 m².

Construction cost: 3 000 000 €

[SEE ONLINE](#)